

ASSEMBLY INSTRUCTIONS

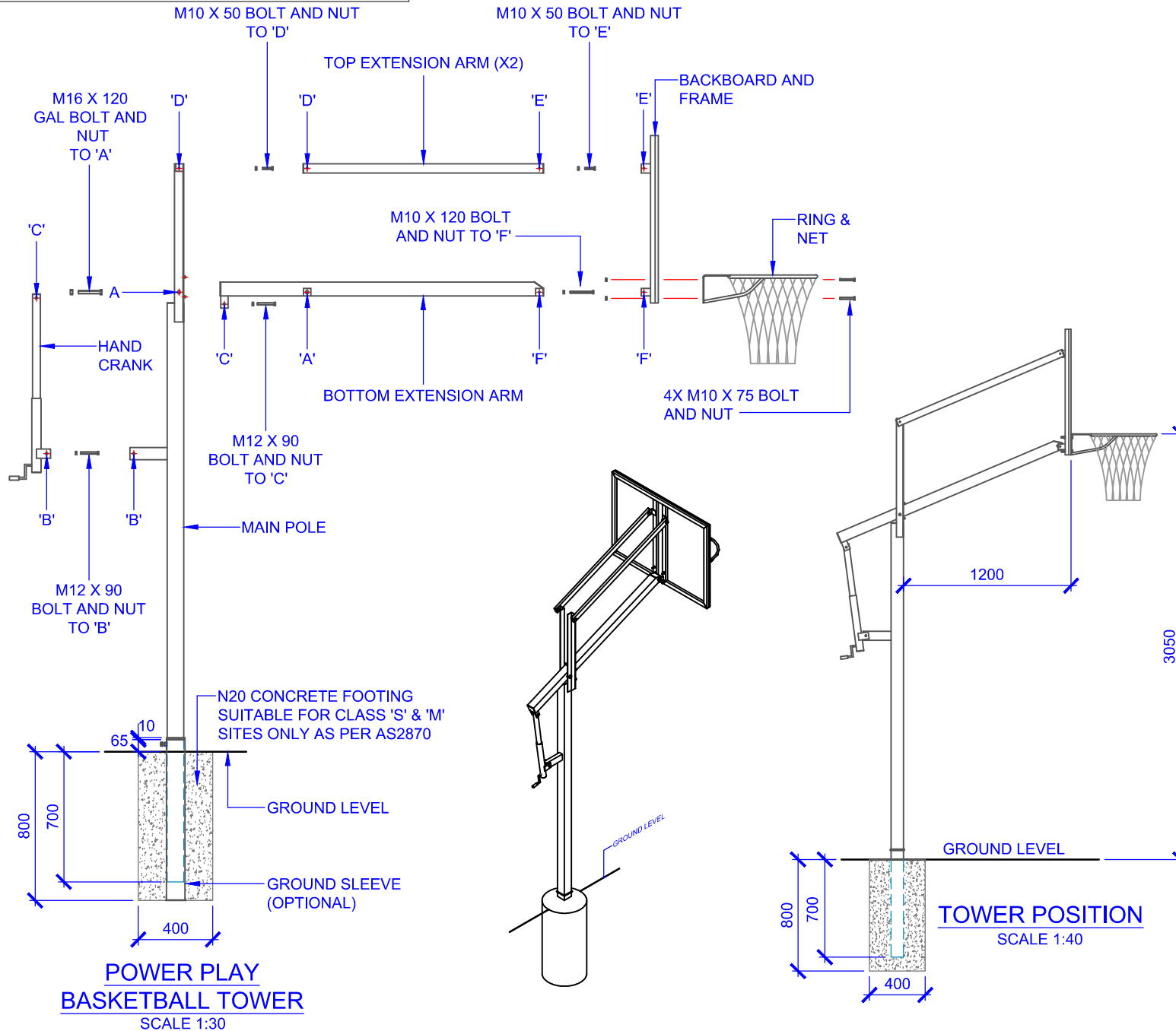

COMPONENTS

QTY	ITEM
1	MAIN POLE
2	TOP EXTENSION ARM
1	BOTTOM EXTENSION ARM
1	HAND CRANK
1	BACKBOARD AND FRAME
1	RING AND NET
4	M10 X 50 BOLT AND NYLOC NUT
4	M10 X 75 BOLT AND NYLOC NUT
1	M10 X 120 BOLT AND NYLOC NUT
2	M12 X 90 BOLT AND NYLOC NUT
1	M16 X 120 GAL BOLT & NYLOC NUT
1	100 X 100 MM GROUND SLEEVE (OPTIONAL)
-	-
-	-

TITLE: **POWER PRO**

DRAWING NUMBER: **POWER PRO ASSEMBLY**

WEIGHT: - CUBIC MEASURE

Oz Ring Pty Ltd
Trading as:
Play Hard Sports Equipment
ABN 79 066 094 559
24 Ern Harley Drive
Burleigh Heads Qld 4220
Phone: (07) 5593 4494
Fax: (07) 5593 4338
Website: www.playhardsports.com.au
Email: email@playhardsports.com.au