

# ASSEMBLY INSTRUCTIONS

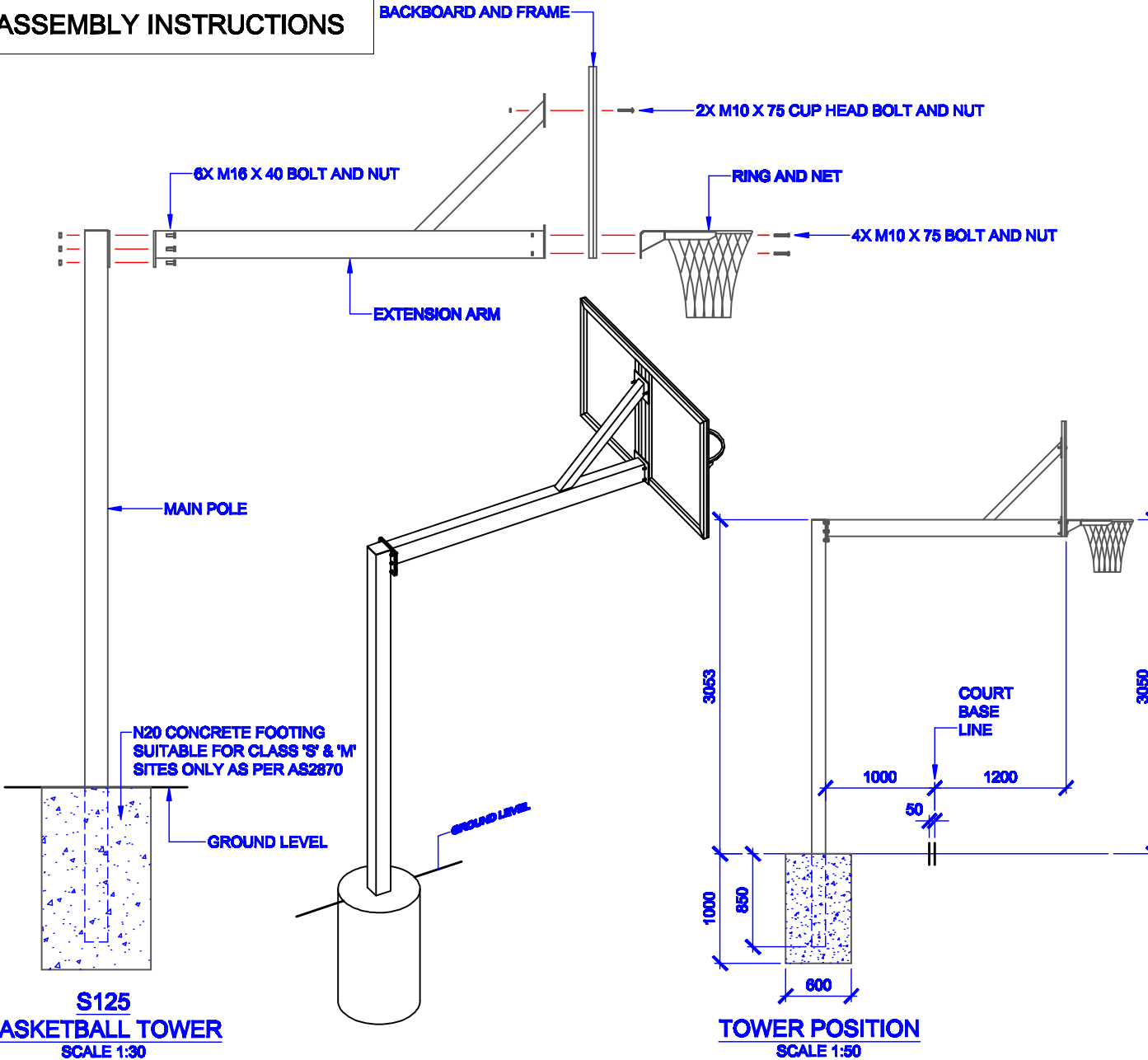

**S125 BASKETBALL TOWER**  
SCALE 1:30

**TOWER POSITION**  
SCALE 1:50

# COMPONENTS

QTY	ITEM
1	MAIN POLE
1	EXTENSION ARM
1	BACKBOARD AND FRAME
1	RING AND NET
6	M16 X 40 BOLT AND NUT
2	M10 X 65 CUP HEAD BOLT AND NUT
4	M10 X 75 BOLT AND NUT
-	-
-	-
-	-
-	-
-	-
-	-
-	-
-	-

TITLE: **S125 BASKETBALL TOWER**

DRAWING NUMBER: **S125 ASSEMBLY REV D / 201109**

WEIGHT: <b>141 kg</b>	CUBIC MEASURE: <b>0.6m3</b>
-----------------------	-----------------------------



**Oz Ring Pty Ltd**  
Trading as:  
**Play Hard Sports Equipment**  
ABN 79 066 094 559  
24 Em Harley Drive  
Burleigh Heads Qld 4220  
Phone: (07) 5593 4494  
Fax: (07) 5593 4338  
Website: [www.playhardsports.com.au](http://www.playhardsports.com.au)  
Email: [email@playhardsports.com.au](mailto:email@playhardsports.com.au)